

## Refrigerated bases 2-Drawer Chef Base Refrigerator 62" Long

ITEM # \_\_\_\_\_

MODEL # \_\_\_\_\_

NAME # \_\_\_\_\_

SIS # \_\_\_\_\_

AIA # \_\_\_\_\_



738311 (KCHCB60R)

2-Drawer Chef Base  
Refrigerator 62" Long

### Short Form Specification

**Item No.** \_\_\_\_\_

Refrigerated base with exterior back panel in stainless steel, bottom panel in galvanized steel, exterior side panels and top in 430 stainless steel; interior back, bottom and interior side panels in 304 stainless steel. Top in 430 stainless steel. Electronic temperature control.

R290 gas in the refrigeration circuit.  
ETL Safety and Sanitation certified.  
3/5 Years warranty.

### Main Features

- External temperature display.
- Cabinet completely insulated with high density polyurethane for low environmental impact.
- Recommended maximum temperature on worktop surface is 572°F.
- Insulation of the top guaranteed thanks to the Integrated ceramic fiber heat shield.

### Construction

- Pre-wired heavy duty power cord.

### Sustainability

- CFC and HCFC free, highly ecological refrigerant type: R290 (ecological gas in foam: cyclopentane). Hydrocarbon refrigerant gas R290 for the lowest environmental impact (GWP=3), to reduce green house and ozone depletion effects.
- High efficiency components to minimize the energy consumption still guaranteeing the highest performances.
- Hydrocarbon refrigerant gas R290 for the lowest environmental impact (GWP=3) - CFC and HCFC free.

### Optional Accessories

- 1 ADJUSTABLE FOOT PNC 206445

APPROVAL: \_\_\_\_\_

### Front

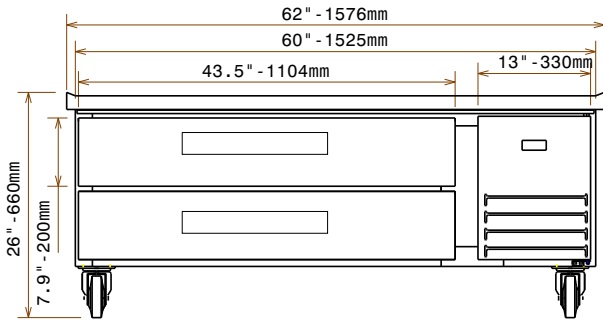

### Side

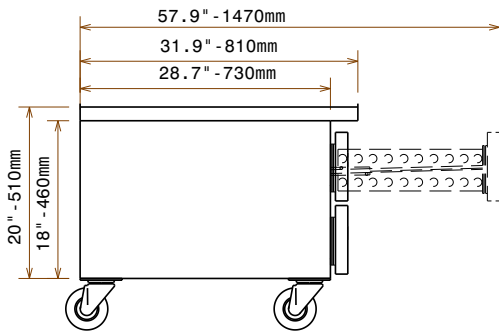

EI = Electrical connection

### Top

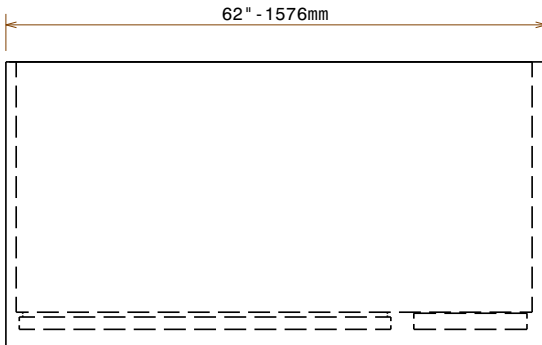

## Electric

### Supply voltage:

738311 (KCHCB60R) 115 V/1 ph/60 Hz

### Electrical power, max:

0.22 kW

### Total Watts:

0.22 kW

### Plug type:

USA NEMA 5-15P

## Key Information:

External dimensions, Width: 62 1/4" (1575 mm)

External dimensions, Depth: 31 7/8" (810 mm)

External dimensions, Height: 26" (660 mm)

### Gross capacity:

Net weight: 269 lbs (122 kg)

Shipping width: 32 7/8" (835 mm)

Shipping depth: 63 3/16" (1605 mm)

Shipping height: 28 3/8" (720 mm)

Shipping weight: 298 lbs (135 kg)

Shipping volume: 34.07 ft<sup>3</sup> (0.96 m<sup>3</sup>)

## Refrigeration Data

Refrigerant weight: 0.176 lbs (80 g)

## Sustainability

Current consumption:

2.1 Amps

Refrigerant type:

R290